



**The Easy Way to Green Grass**

**Featuring:**

# **Watering Made Easy Sprinkler Stations**

**The redefinition of lawn watering**



**2008**

**Product  
Catalog**

**The Original  
Sprinkler Station™  
in action!**

# Sprinkler Stations

## The Original Sprinkler Station™



- 70 ft. diameter impact sprinkler
- UPC: 857277000116

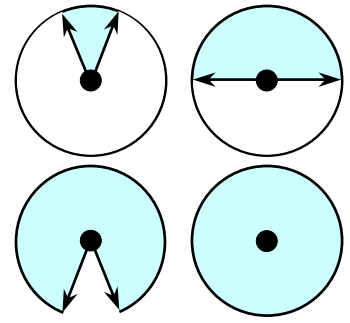

30°-300°, 360°  
70 ft diameter

## The Sprinkler Station Jr.™



- 30 ft. diameter mist
- UPC: 857277000123

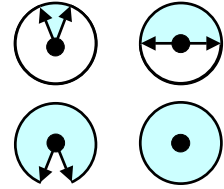

15°-360°  
30 ft diameter

## The Sprinkler Station Squared™



- 9 x 18 ft., 4 x 15 ft. or 4 x 30 ft. rectangle mist
- UPC: 857277000130

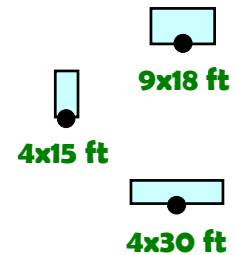

## Watering Made Easy Sprinkler Stations

- Stays in place, stays aimed
- Hides underground, no need to move to mow
- Hassle-Free, no trenches, installs in minutes
- Quick connector included. Garden hose clicks on & off, no screwing
- Many yards require 3 Sprinkler Stations
- 3 Styles

### Basic Installation Instructions

1. Dig a 10" hole and place the sprinkler.

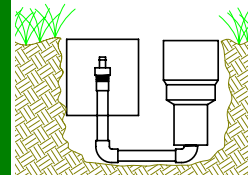

2. Fill the hole with dirt and gravel. (Not included)

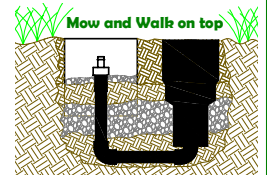

3. "Click" your hose onto your new Underground Sprinkler Station!

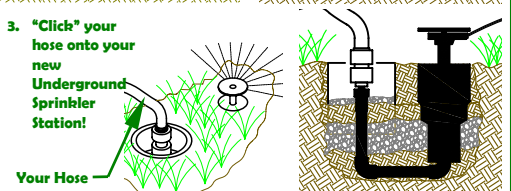

# Accessories



**A21**

## Winterizer Kit

- Use to prepare for winter freeze
- Trigger pump and 7 corks with instructions
- UPC: 857277000215

**A22**

## Replacement Cap



- Cover the hose connection
- UPC: 857277000222



Zinc



Plastic

**A27**

## Y Splitter w/ shut off valves

- Attach 2 hoses to one spigot

**A28**

## Brass manifold w/ shut off valves

- Attach 4 hoses to one spigot



**A30a**

## Flashlight Nozzle

- Shower spray
- Really lights up!



**A30b**

## Power Nozzle

- Powerful adjustable spray



**A26**

## Shut off Timer

- Attach to spigot
- Turns off water after set time



**A23**

## Female quick connect w/ shut-off

- Attach to hose end
- Connects to A24 and A25



**A24**

## Male quick connect w/ female hose thread

- Attach to spigot
- Connects to A23



**A25**

## Male quick connect w/ male hose thread

- Attach to accessories
- Connects to A23



\*Items may differ from images shown



**The Easy Way to Green Grass**

**Watering Made Easy, Inc.**

**PO Box 5058**

**Kingwood, TX 77325-5058**

**877-280-4485**

**801-409-9033 fax**

**[www.WateringMadeEasy.com](http://www.WateringMadeEasy.com)**



**2008**

**Product  
Catalog**

**Watering Made Easy reserves the right to change  
products at any time without prior notice**

**©Watering Made Easy, 2008**